

- ① Follow Focus 302-0204
- ② Base Plate 303-0202
- ③ Shoulder Pad Unit 303-0201
- ④ Add-on Bracket 303-0207
- ⑤ Anti-skid Handgrip 303-0212
- ⑥ Battery Bracket 306-0205
- ⑦ Topside Handgrip 303-0213
- ⑧ Rail Monitor Bracket 303-0215

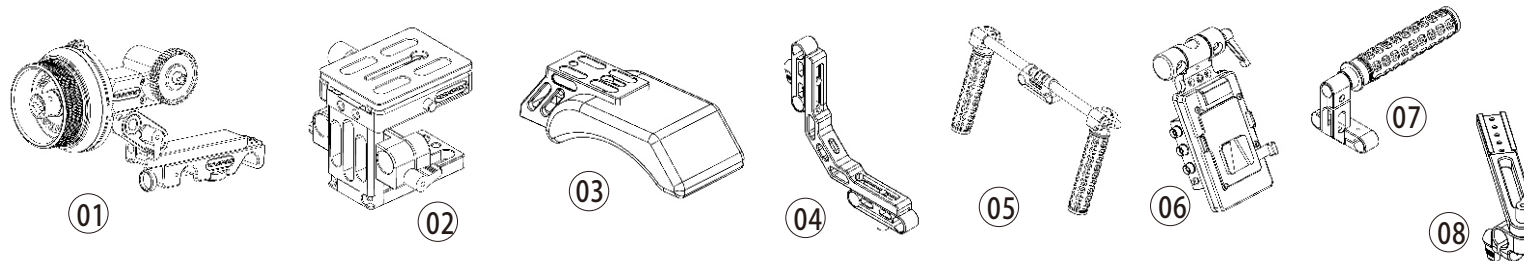

# Kit D

Lite configuration

Tel: 86 755 8311 4888 Fax: 86 755 8311 5333  
[Http://www.movcam.com](http://www.movcam.com) eMail: mov800@movcam.com

**MOV CAM**®

**Movcam Tech. Co.,Ltd**

Floor 6 North, Antong Building, #207 Meihua Road, Futian District  
 Shenzhen, Guangdong Province 518049, P.R. of China